

This edition - sponsored by a kind villager



Issue 163

September 2023

Osmotherley Area Messenger

Osmotherley Primary School



PHOTOGRAPHY

A laidback experience with first-class results, we put even the most camera-shy at ease.

- Equestrian
- Pets
- Family
- Weddings
- Commercial

Contact: 01642 214008

www.mhgphotography.co.uk



Delightful Holiday Cottage to Rent

Delightful Holiday Cottage to Rent

10 West End, Osmotherley
Beautifully refurbished

3 bedroom country cottage,
sleeps 5, in Osmotherley

Available for holiday let, full or
part-time.

Visit our website:

www.yorkshireholidayrentals.com

or enquiries at the

Thimbleby Estate Office:

01609 883205

sally@thimblebyestate.com



The summer term at school is always busy but this year we also received our long-awaited Ofsted inspection. The inspectors spent two days with us and their glowing feedback reflected all the hard work of the staff, governors and pupils since their last visit.

The report describes Osmotherley School as a happy, caring and nurturing school where children enjoy their learning. The inspectors were impressed by the children's eagerness to share their knowledge in a range of subjects and they were delighted when a group of Reception children, chatting over lunch, explained to them that you need to practise a lot and read a lot to be a good learner at Osmotherley School.

We are very proud of our lovely school and we are also very grateful for all the support we receive from our families and the community.

Osmotherley and District Garden Club: Our next meeting is to be held on Tuesday 29th August at 7.30pm in the Village Hall, where we have a talk on 'Wildflower Gardening'. Members and guests welcome, the latter for £2 pp. The Chair has asked the speaker to include how to establish both a small annual wildflower area and also a perennial one. In addition, converting grass to a meadow and which wildflowers are best to use for attracting pollinators.

We look forward to seeing you. Any queries contact ossygardenclubsec@gmail.com



IYENGAR
YOGA
CLASSES

Osmotherley Village Hall

Tuesday 6-7pm

Thursday 2-3pm

Thursday 5.45-7pm

Thursday 7-8pm (men only)

Catholic Church N'allerton

Tuesday 10.30-11.30am

Butterflies Dance Studio

Thirsk

Tuesday 7.30-8.30pm

Methodist Hall N'allerton

Wednesday 6.15- 7.15pm

To book contact: Helen

Cameron 01609 883293,

07990784081



WOODLANDS FARM

THIMBLEBY

Luxury Rural Accommodation

AA 5 Gold Star for Guest
Accommodation, Breakfast
Award and 5 Star Self-
Catering.

Rooms feature TV/DVD,
locally made oak furniture,
Roberts Radio Fridge/Minibar
and ensuite

Fully licensed

CCTV/Off-Street Parking

Open all Year Round.

Tel: 01609 883524

www.woodlandsfarmthimbleby.com

Bats in the Belfrey

Some villagers will have experienced the peal 4 ringers attempted to ring for the coronation of King Charles III. The group managed to make a noise [!] for 15 minutes or so but sadly the second bell gave up when the rope snapped and following a further inspection this bell must now remain out of operation.

At the PCC meeting last month three options were considered

Option 1 would be to do the bare minimum.

Option 2 would add the missing bell in the current ring of 3 to make a ring of 4 bells. The set of 4 would be tuned and made compatible with each other. This would involve opening up the bell tower to get the new bell in position and take the others out for servicing and tuning.

Option 3 would involve the installation of a ringing gallery above the kitchen so that a peal of 6 could be rung. Apart from the considerable cost of this option there is also the question of how acceptable it is to add a ringing gallery in an ancient building. This has however been done very successfully in many ancient churches around the country but we need to have guidance from the York Diocese to seek their opinion on the scheme and then decide if it is an option.

Meanwhile we have been offered bells and technical support from several quarters and so I plan to organise a village bell meeting to see how we can jointly restore and develop this historic part of our village.

Whichever option is chosen the bells would be installed with the ability to be rung electronically.

Incidentally as a result of specialists visiting St Peter's to give advice they have noticed that there is a Saxon grave stone built into St Peter's north wall but sadly with a drain pipe bracket drilled into it [!] and we also have pipistrel bats in and around the church.

Pictures below show how the ringing gallery could be accommodated should option 3 be considered.

We have a group of villagers who have shown interest in this project (this information has already been shared with them by email), but should you wish to be included with them in future meetings and emails then please contact me by email on m.hunter@fleetfactors.co.uk

Mike Hunter 07711 082829



Current kitchen

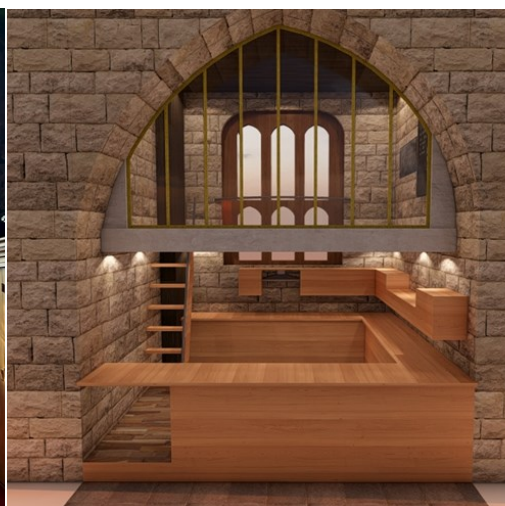

Kitchen with ringing platform



Ringing platform

Osmotherley Community Group

Following the annual review meeting in July, Eileen Bellett and Michelle Wood have stepped down from their roles as Chair and Treasurer. After 10 years of service, it is now time for others to coordinate activity. During the transition period, and in conjunction with any emerging leadership, St Peter's PCC will be responsible for overseeing community related events in the church facilities.

If you would like to get involved please contact Revd Bill Dewing on 01609 882233.

Eileen and Michelle would like to personally thank everyone who has volunteered their time and skills to support the work of Osmotherley Community Group - the last 10 years would simply not have been possible without your help. We hope that you will continue to support in the future. Thank You. *Eileen Bellett*

A New Direction

As detailed above, the Osmotherley Community Group as we have known it has come to an end. I am sure we would all want to express our heartfelt thanks to Eileen Bellett, Michelle Woods and to all the team who have worked so hard and done so much for the community over the past 10 years.

To discuss how we might be able to take things forward there will be a meeting at The Old Vicarage at 6pm on **Tuesday 26th September**. All who are interested in helping to shape and support a community group in the village are welcome to come along.

Thank you *Rachel*



NEW SEASON NEWS... As 'The Messenger' prepares for press we are working to put the final pieces of the season in place. Please stay tuned for local publicity to come. Season 2023-24 will be there for you to enjoy!

As always, we will look forward to welcoming past members and, likewise, newcomers. The support of members, through the membership fee, is what makes the season of film possible: Members make it happen! Join us to enjoy the season with us!

Our '3rd Friday' tradition for our film evenings will be there. Another cinematic journey through film and film-world awaits – the best of British cinema; World Cinema; drama, thought-provoking moments; film and film evenings to enjoy. That's the Osmotherley Film recipe!

At its fullest extent, our film dates, (as we are planning for) = Sep 15; Oct 20; Nov 17; Dec 15; 2024: Jan 19; Feb 16; Mar 15; Apr 19; May 17; Jun 21.

Full details of the new season will be publicised shortly including confirmed dates; film programme; membership fee.

It's been a busy summer for those behind the scenes at Osmotherley Film. We are also currently operating without a full-strength film crew. But we very much believe in the 'magic of film' and recognise the enjoyment it brings to our audiences. We are looking forward to the new season – we hope you are!

To contact us: email osmotherleyfilm@gmail.com

(Our website is currently in the process of moving server and will be back online as soon as this is complete).

Should you wish to join the film crew & be part of making it all happen – simply get in touch with us.



OPENING HOURS

Wednesday – Monday
9am - 4.30 pm

(closed Tuesdays until
November 30th, then closed
Tuesday and Wednesday until
March)

See 'Dates for your Diary'
for Autumn closures

Tel : 07980208034

Email:

trevorbrooks7@hotmail.com

Cote Ghyll Mill

Osmotherley, DL6 3AH

Cote Ghyll Holiday
Apartments, Osmotherley, DL6
3AH

- * Four newly refurbished holiday apartments.
- * Self-catering accommodation, fully fitted & equipped kitchens, bathroom/shower room
- * Drying/laundry facilities available
- * Free WiFi & parking

mill@coteghyll.com

www.coteghyll.com

01609 883425

Oak Garth Motors

Full servicing and repairs on all makes and models of vehicles

New vehicles serviced with genuine parts to maintain warranties.

MOT preparation & presentation.

Fitting of Exhausts, Tyres, Batteries.

Air con servicing & repairs.

Tel - 01609 883781

Editorial Team:

Contact us on -

os.messenger@googlemail.com

Articles for October issue by
Friday 22nd September 2023



Locally sourced meat, bread,
eggs, milk, fresh fruit and
vegetables.

Brymor ice-cream and local
honey also in stock.

Dry-cleaning and laundry
services available. Logs,
kindling, stamps and daily
newspapers.

Tel: 883251

Facebook:

@TopShopOsmotherley

Swales

Clack Lane Garage
Osmotherley
Tel: 01609 883263

- Car and van hire
- MOT testing
- Servicing
- Car sales
- Tyres
- Recovery
- Domestic fuel

www.swalesgarage.co.uk



Hard&Soft Landscaping Fencing
Light Ground Works Grass Cutting
Concrete Bases Turf laying
Draining & Ditching Lawn Care
Patios Garden Clearing
Paddock Maintenance Hedge Cutting
Commercial Ground Maintenance

Phone: 07971300997

marcus@pearsongroundservices.com

pearsongroundservices.com



Dates for your Diary

August

Tues 29th, 7.30pm. Garden Clun talk 'Wildflower Gardening' Village Hall.

September

Tues 12th, 9.30am. OWLS outing to Middleham stables.

Fri 15th 7.30pm. Osmotherley Film, To be Decided, Village Hall.

Tues 26th, 6pm. Community Group Meeting. The Old Vicarage

Sat 30th - Wed 4th October . Coffee Shop closed.

October

Tues 31st - Thurs 30th November . Coffee Shop closed. (Closed Tuesdays until 30th November then closed Tuesdays and Wednesdays until March.)

Osmotherley Area Parish Council-July

The council members met for the final meeting before our summer recess and was well attended, including three members of the public.

The Chairman updated members on the his meeting with the owner of the QC and Three Tuns public houses. This has helped improve communication and it is hoped will ensure any issues or concerns are raised between both organisations in the future.

Various highway and other maintenance issues were discussed including damaged bollards, road surfaces and village green set repair. The bog hole footpath has also been approved to have a continuation of the tarmac footpath laid to the Osmotherley side of the bridge. The outcome of the survey of the village trees is that a small amount of work to trees for safety reasons, is required.

The owners of the Methodist Church have welcomed our comments and those from residents for the future use.

The war memorial maintenance is now to be carried out by a group of residents and the PC thanks them for continuing the work done by other residents in the village.

The lack of a police presence at future Remembrance Sunday events was reported and discussions are ongoing as to how the traffic will be managed.

The parking of cars on the village green at Robin Hill has been discussed and a temporary solution of rocks, strategically placed, is hoped to be effective.

John Robinson, Clerk to the Parish Council, 07801591566

Do you want to advertise in the Messenger?

We have space for one more advert.

Cost is £70 per annum (10 editions).

OWLS : Outing to Middleham Stables on Tuesday 12th , please meet at The Queen Catherine at 9.30 where the mini bus will pick us up . Please bring £30 s for the visit and £5 contribution to the cost of the mini bus .

Mobile Library

Dates for the mobile Library are as follows:

Thursday 7th September, Thursday 5th October, Thursday 2nd November
10am to 12 noon The library stops at the entrance to the Oswaldene estate.

Village Hall Bookings: Please contact Clare Scott via

bookings@osmotherleyvh.org.uk

Quaker Meeting House Bookings - Available for bookings. (Costs are £12/half day or £24/full day. Contact Annie Peart (Anniepeart@live.com))